



PRODUCT INSTALLATION GUIDE

M93



Product Size : 74*61 (66) *120(138)CM

Caution ! only adults are allowed to install, keep children away

Accessories list

 castor*5	 base*1	 mechanism*1	 armrest*2	 seat cushion*1	 backrest*1
 gas lift*1	 hexagonal wrench*1	 small gasket*4	 headrest*1	 mechanism screw*4	 back plate screw*3
 large gasket*2	 headrest screw*2	 armrest screw*2	Caution ! all accessories , prevent children from swallowing		

Installation diagram

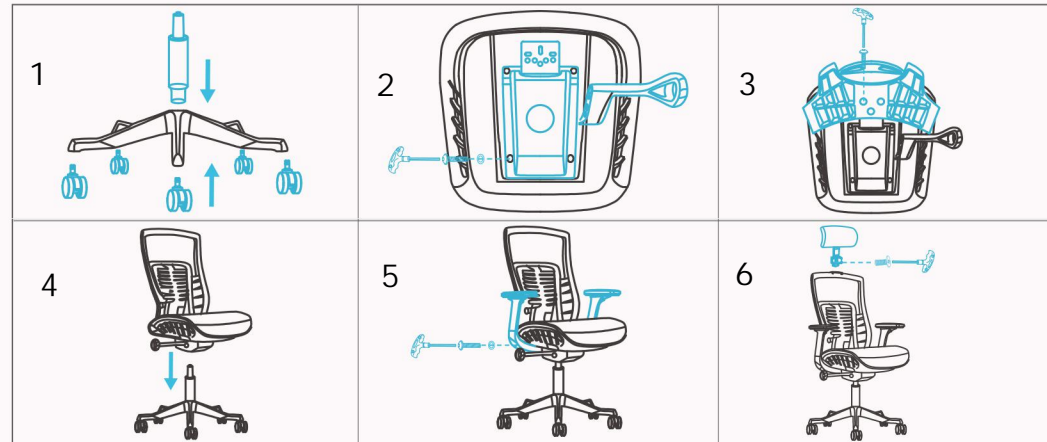

1. Press the caster into the base;
Put the gas lift into the middle hole of the base.
2. Use 4pcs M6*16 mechanism screws and small washers to install mechanism on the seat cushion
3. Connect the backrest and seat cushion with 3pcs M8*20 back steel plate screws
4. Align the upper part of the assembled chair and insert the gas lift
5. Use 2pcs M8*50 armrest screws and the washer to install the armrest on the chair
6. Use 2pcs M6*14 headrest screws to install the headrest on the chair, and the chair installation is complete