

M84C

PRODUCT INSTALLATION GUIDE



Product Size: 64*64.5*111(127)CM

Caution! only adults are allowed to install, keep children away

Accessories list (subject to actual size, each type of screw has extra for spare unit: piece/set)

wheel *5	chair leg*1	mechanism*1	armrest*2	hex wrench*1
seat cushion*1	backrest*1	gas lift*1	large gasket*3+1	hanger*1
small gasket*10+1	armrest screw (M6*30)*6+1	back steel plate screw (M8*25)*3+1	Mechanism screw (M6*20)*4+1	Caution: Before installing the chair, please sort the screws and measure the length of the screws for installation.

Installation diagram (subject to actual size)

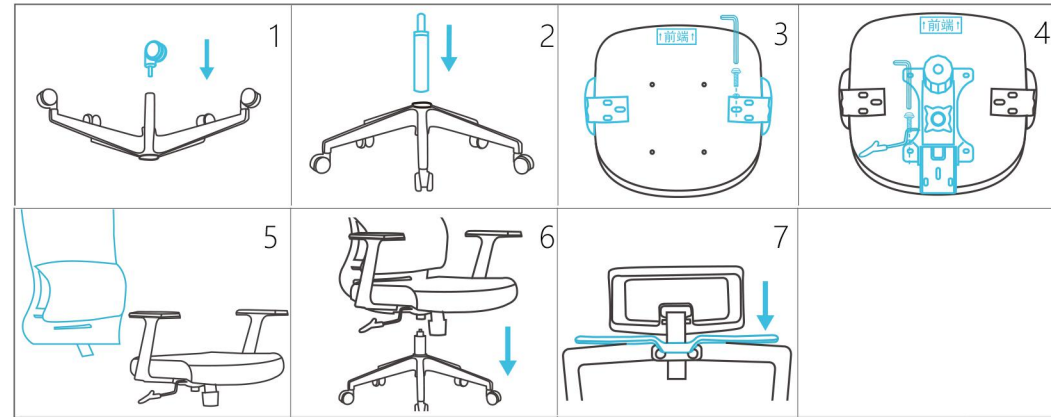

1, Press the wheel into the chair leg.

2, Put the gas lift into the middle hole of the chair leg.

3, Use 6 M6*30 screws and small washers to connect the seat cushion and the armrest.

4, Connect the seat cushion and mechanism with 4 M6*20 screws and small washers.

5, Use 3 M8*25 screws to enlarge the gasket to connect the seat cushion and the back steel plate.

6, Align the upper half of the assembled chair and insert the gas lift.

7, Insert the hanger directly into the headrest and the chair is installed.